

This drawing is the property of Bradley Murphy Design Ltd. Copyright is reserved by them and the drawing is issued on the condition that it is not copied, reproduced, retained nor disclosed to any unauthorized person either wholly or in part without the consent of Bradley Murphy Design Ltd.

NOTES: Based on OS Base

 Outline planning application boundary (3.63ha)

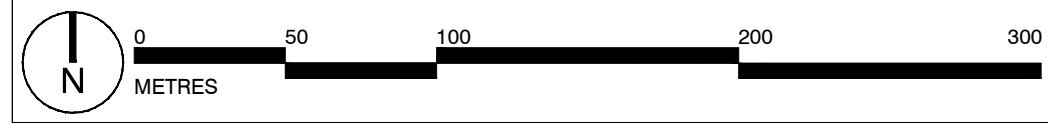
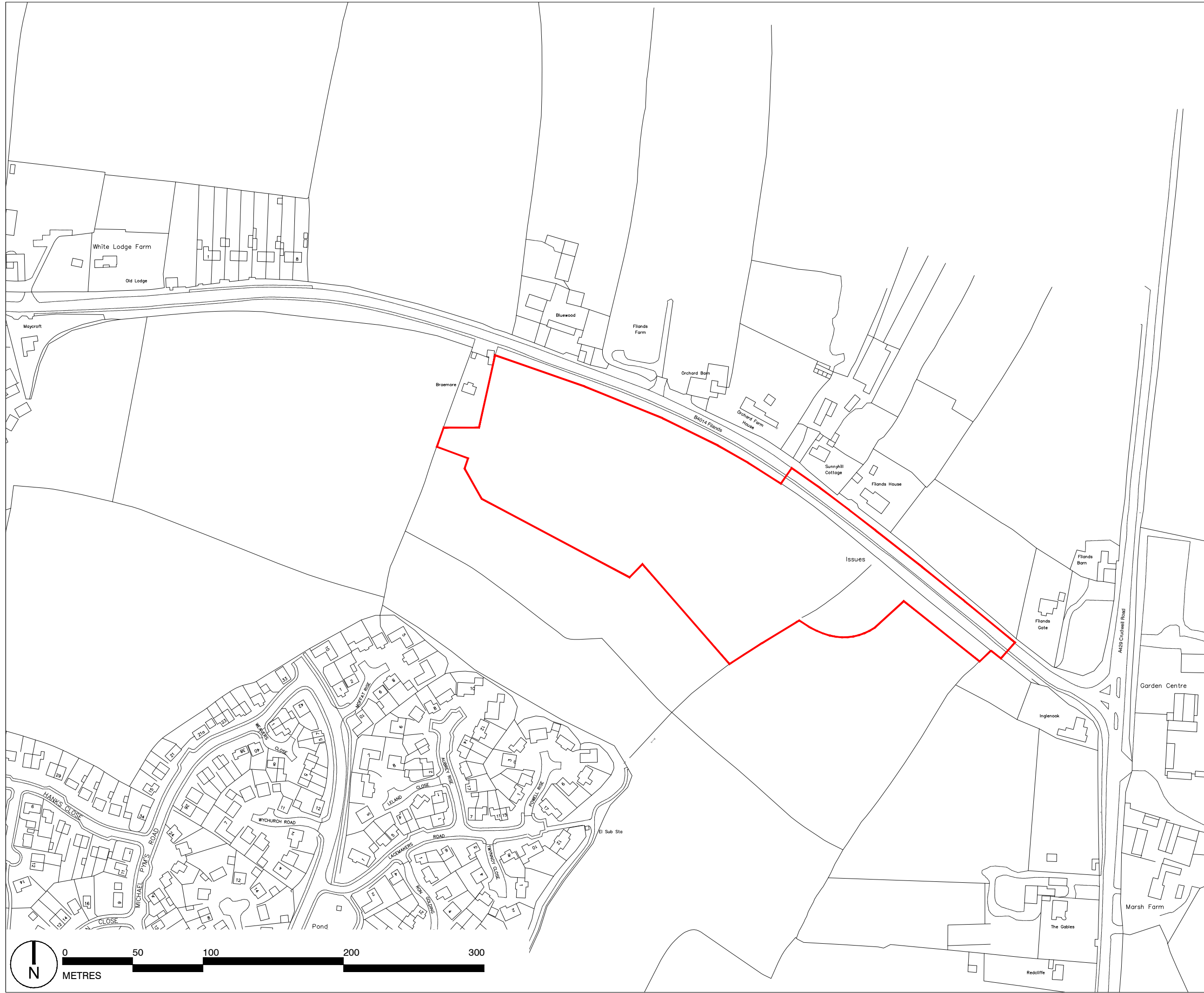

Rev	Description	Date	
	Purpose of Issue		
	FOR PLANNING		
Bradley Murphy Design Ltd 5 The Courtyard Hatton Technology Park Dark Lane Hatton Warwickshire CV35 8XB t: 01926 676496 e: info@bradleymurphydesign.co.uk www.bradleymurphydesign.co.uk Client			
BMD			
LANDSCAPE DESIGN PLANNING			
GLEESON DEVELOPMENTS LTD			
Project			
Land South of Filands			
Drawing Title			
Planning Application Boundary			
Drawn EM	Checked EM	Approved RM	Date 29/06/2016
Job No. 15.019	Scale 1:2500	Sheet Size A3	Revision
Drawing Number BMD.15.019.DR.P001			-