

Revisions

A 18 JULY 18

INTERNAL LAYOUT OF PROPOSED CONVERSION AMENDED TO SUIT REVISED FRONT ENTRANCE DOOR POSITION TO EAST ELEVATION.

PARKING AREA AND NEW VEHICULAR ENTRANCE RE-LOCATED ONTO EAST SIDE OF SITE USING ADDITIONAL AREA OF ADJOINING FIELD OWNED BY APPLICANT.

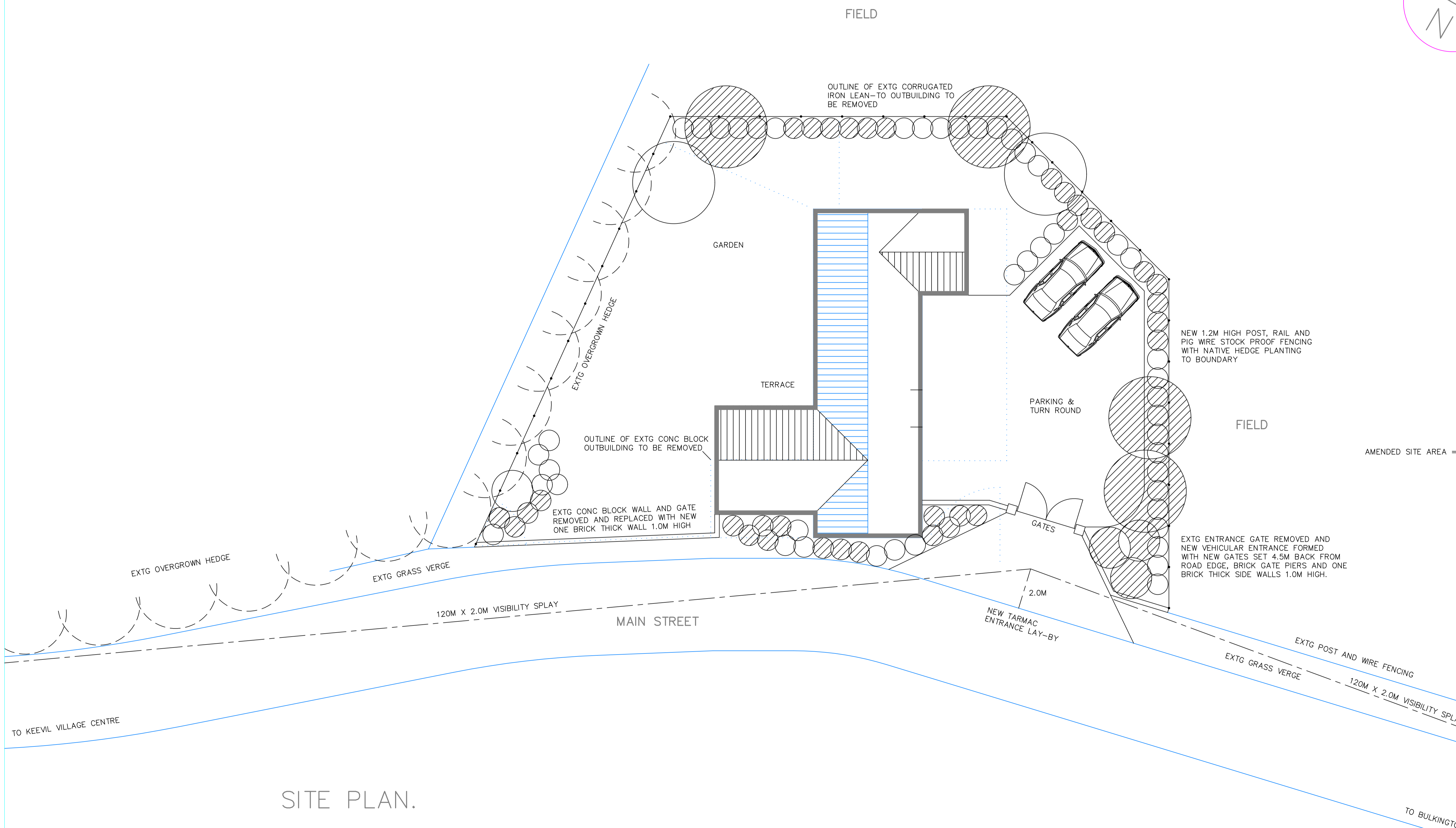
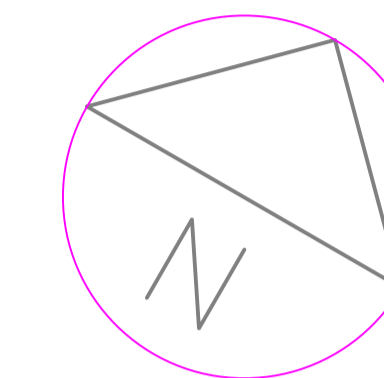

AMENDED SITE AREA = 0.0585 ha

SITE PLAN.

Client  
MR STEPHEN FRY.

Project  
PROPOSED CONVERSION OF EXISTING FARM BUILDING TO FORM SINGLE DWELLING, ELM LEAZE FARM, MAIN STREET, KEEVIL, TROWBRIDGE, WILTSHIRE. BA14 6NE

Drawing Title  
DESIGN DRAWING. SITE PLAN.

Scale	Date	Drawn by
AS INDICATED	NOV 2017	

**Tim Weeding Building Design Services**  
30 Mill Road  
Worton  
Devizes  
Wiltshire SN10 5SP  
Telephone & Fax : (01380) 728903

Project Number	Drawing Number
2017-62	06A

0 1 2 3 4 5 10  
SCALE 1/100 WHEN PLOTTED AT A1 SIZE  
SCALE 1/200 WHEN PLOTTED AT A3 SIZE